

CERTIFICATE OF LOCATION OF GOVERNMENT CORNER

EAST QUARTER Corner of Section 21, Township 105 N., Range 42 W., 5 th P.M.

STATE OF MINNESOTA, County of MURRAY

At the corner location shown on the sketch:

On 8/20/92 found a 1/2" X 16" REBAR WITH RLS CAP #12967 OVER STONE
DATE

left monument as found, lowered monument, removed monument (explain)

On _____ Placed a _____
DATE

SKETCH OF REFERENCE TIES



DNR DISC AND NAIL
SW SIDE POWER
POLE UP 1.0'

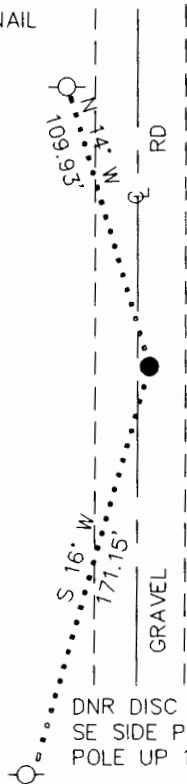

NOTE:
MONUMENT IS
2.1' E. CL N-S ROAD

1983 MURRAY COUNTY
COORDINATE SYSTEM
N = 113385.942
E = 469070.192

BEARINGS OBSERVED WITH COMPASS

Statement of evidence relative to this corner location is on back of page. 10/7/92
WMA01187.00.00.01

I hereby certify that this document and the data contained herein was prepared by me or under my direct supervision.

Lowell R. Pommeroy SIGNATURE 10-26-92 DATE

Registration No. 17005

- Land Surveyor, Professional Engineer
 County Surveyor, County Engineer

OFFICE OF THE COUNTY RECORDER

County of MURRAY

I hereby certify that this document was filed in the Co. recorders office at _____ .M. on the _____ day of ACT 27 1992 A.D., 19__

County Recorder J. Ann V. Johnson
By _____, Deputy

DOCUMENT NO. _____

East Quarter Corner Section 21, Township 105 North, Range 42 West

The DNR Bureau of Engineering contacted the following offices for information on this corner:

MN Secretary of State
Murray County Recorder and Highway Engineer
Moseng Land Surveying at Marshall
Madsen Land Surveying at Fairmont

- 1861 The U.S. General Land Office notes, on file in the Secretary of State's Office, show the corner marked with a post, made mound with trench and pits as per instructions.
- 1930 Surveyor's Record Book A, on file in the County Recorder's Office, on page 358, states the following; "Stone established on line stone 8 x 12 x 24". Corner is shown to measure 2637.9 ft. from adjoining section corners.
This information is also on file in the County Highway Engineer's Office.
- 1931 Surveyor's Record Book A, on file in the County Recorder's Office, on page 372, states the following; "Stone 2 on top". This information is also on file in the County Highway Engineer's Office.
- 1980 Field notes, obtained from Madsen Land Surveying, for a survey done by Gary Martin, RLS, show this corner was excavated. Found a stone with a point up 1.0 ft east of the centerline of a north-south road in line with field division west and fence line east. Stone was found down 0.8 ft, lowered same to 1.5 ft. and set a 1/2" capped rebar over the stone. Stone is shown to measure 2636.92 ft. from the southeast corner Section 21.
- 1992 August 20, the DNR Bureau of Engineering conducted a search for this corner and found a 1/2"x 16" rebar over a large pointed stone down 1.8 ft. Set a 3/4"x 24" rebar on the north side of the stone and replaced the 1/2" rebar as found. Rebar has a plastic cap stamped #12967 MARTIN. Rebar was found to measure:
2636.09 ft. from the northeast corner Section 21
2637.15 ft. from the northeast corner Section 28

Analysis of the available information led the DNR Bureau of Engineering to conclude that the found stone and rebar mark the location of the corner.